

97000-RD Series

Refrigerated "Deli" Display Cases

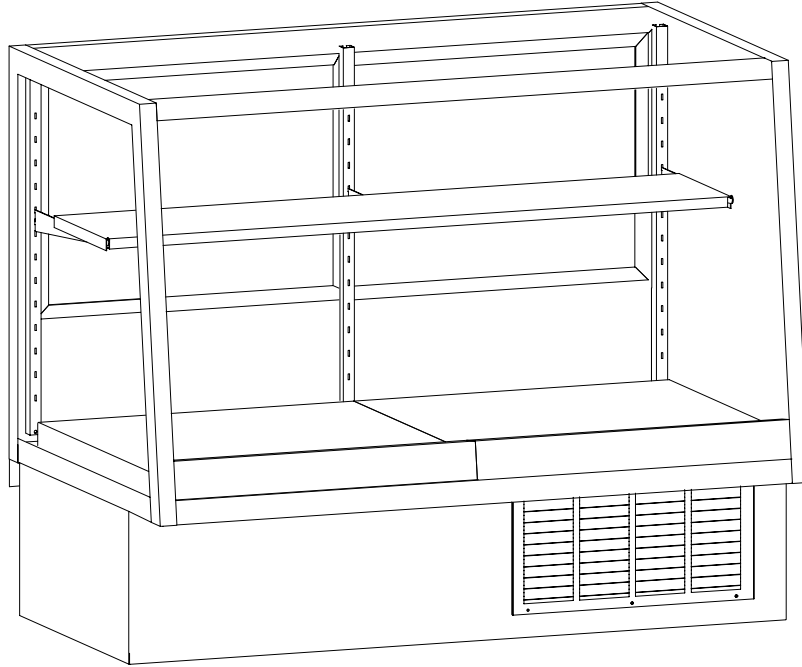

Features & Finishes:

- Insulated Glass for Maximum Efficiency
- Solid Top & Insulated Solid Ends
- Anodized Aluminum Frame
- Framed, Sliding, Insulated Mirror Doors
- Top Light and Shelf with Lamp & Shield
- 12" Deep adjustable Stainless Steel Mezzanine Shelf
- Heavy-Duty 14 Gage Steel Base
- Rear Grille
- Self-Contained Refrigeration Unit in Base
- Refrigeration Unit Removable for Ease of Maintenance & Cleaning
- 120 Volts - 60 Cycle - Single Phase
- Automatic, Energy Saving, Condensate Evaporator
- 10' Cord, Plug & Switch
- U.L. & C.U.L. Listed
- "ETL" Sanitation Listed (Conforms to NSF STD-7)



97000-RD Series Refrigerated "Deli" Display Cases

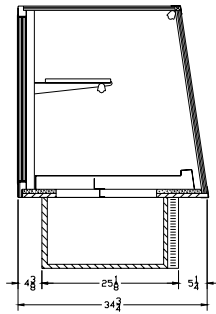

END VIEW

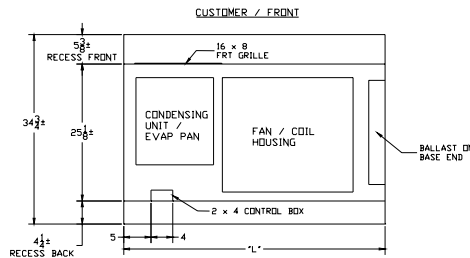

PLAN VIEW

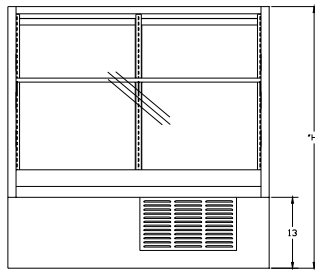

FRONT VIEW

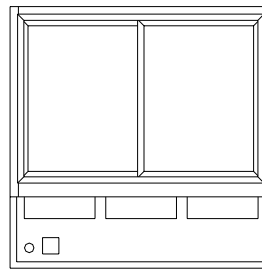

REAR VIEW

Model No.	Dimensions: L X W X H	Rows of Shelves	Est. Crated Weight	Case Options:
97048-48RD	48" X 34 3/4" X 48"	3	790 lbs.	<ol style="list-style-type: none"> 1. Mirror Ends 2. Mirror Doors 3. HPL Finish Cover Front & Ends (Std.HPL) 4. 6"H Add on Base (54" Overall) 5. Stainless Steel Step Displayer with Pans (White Poly) 6. Brasstone, Black, or White Finish (Frame & Lights Only) 7. 8" Wide Prep Shelf (can be folded down or removed when not in use) 8. Extra 12" Deep Mezzanine Shelf with Brackets (no Light) 9. Shelf Light, Lamp & Shield 10. 4 Yr Extended Motor/Compressor Parts Warranty
97048-59RD	59" X 34 3/4" X 48"	3	820 lbs.	
97048-77RD	77" X 34 3/4" X 48"	3	930 lbs.	

Specifications Subject to change without notice



P. O. BOX 470
Union, MO 63084

Phone: 1.800.325.0775

Fax: 1.636.583.4067

Email: sales@spartanshowcase.com

www.spartanshowcase.com